

1.5VL COMPOSITE DECK

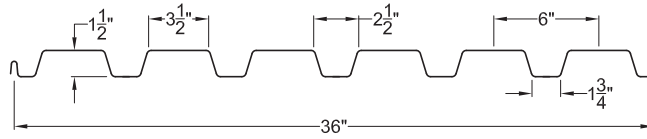

SECTION PROPERTIES

Deck Gauge	Design Thickness (in.)	Deck Weight (psf)	Section Properties				V _a (lbs/ft)	F _y (ksi)
			I _p (in ⁴ /ft)	S _p (in ³ /ft)	I _n (in ⁴ /ft)	S _n (in ³ /ft)		
22	0.0295	1.67	0.139	0.167	0.173	0.177	2626	50
20	0.0358	2.03	0.182	0.218	0.216	0.226	3171	50
19	0.0418	2.37	0.224	0.259	0.252	0.275	3685	50
18	0.0474	2.69	0.265	0.298	0.286	0.314	4160	50
16	0.0598	3.40	0.362	0.389	0.362	0.396	4156	40

(N = 9.35) NORMAL WEIGHT CONCRETE (145 PCF)

TOTAL SLAB DEPTH	DECK TYPE	SDI Max. Unshored Clear Span			Superimposed Live Load (PSF)															
		1 SPAN	2 SPAN	3 SPAN	Clear Span (ft-in.)															
					5'-0	5'-6	6'-0	6'-6	7'-0	7'-6	8'-0	8'-6	9'-0	9'-6	10'-0	10'-6	11'-0	11'-6	12'-0	
3.50 (t=2.00) 33 psf	1.5VL22	6'-4	7'-5	7'-6	314	279	250	206	186	169	154	141	130	120	111	100	87	76	67	
	1.5VL20	7'-7	8'-10	9'-0	345	306	275	249	227	208	171	157	144	134	124	108	94	82	73	
	1.5VL19	8'-1	9'-10	10'-0	372	330	296	268	244	224	207	171	157	146	134	116	101	88	78	
	1.5VL18	8'-7	10'-6	10'-9	395	351	315	285	260	238	220	204	168	156	142	123	107	94	82	
	1.5VL16	9'-5	10'-5	10'-10	397	353	316	286	261	239	221	205	190	156	145	135	119	104	92	
4.00 (t=2.50) 39 psf	1.5VL22	6'-0	7'-0	7'-2	366	325	291	240	216	196	179	164	151	139	129	119	111	103	96	
	1.5VL20	7'-2	8'-5	8'-6	400	356	319	289	263	217	198	182	167	155	143	133	124	115	108	
	1.5VL19	7'-8	9'-4	9'-6	400	383	344	311	283	260	215	197	182	168	156	145	135	126	115	
	1.5VL18	8'-1	9'-11	10'-2	400	400	365	330	301	276	254	211	195	180	167	156	145	136	122	
	1.5VL16	9'-0	9'-11	10'-3	400	400	365	330	301	276	255	236	220	180	167	155	145	136	127	
4.50 (t=3.00) 45 psf	1.5VL22	5'-9	6'-9	6'-10	400	373	307	275	248	225	205	188	173	159	147	137	127	118	109	
	1.5VL20	6'-10	8'-0	8'-1	400	400	366	331	274	249	227	208	192	177	164	152	142	132	123	
	1.5VL19	7'-4	8'-11	9'-1	400	400	393	356	325	269	246	226	208	193	179	166	155	145	135	
	1.5VL18	7'-9	9'-6	9'-9	400	400	400	378	344	316	262	241	222	206	191	178	166	155	145	
	1.5VL16	8'-7	9'-6	9'-10	400	400	400	377	344	315	291	270	222	205	190	177	165	155	145	
5.00 (t=3.50) 51 psf	1.5VL22	5'-6	6'-6	6'-6	400	400	347	311	280	255	232	213	195	180	167	154	143	133	124	
	1.5VL20	6'-7	7'-8	7'-9	400	400	400	375	310	281	257	236	217	200	186	172	160	149	139	
	1.5VL19	7'-1	8'-6	8'-8	400	400	400	400	367	304	278	255	235	218	202	188	175	163	153	
	1.5VL18	7'-6	9'-1	9'-4	400	400	400	400	389	357	297	272	251	233	216	201	187	175	164	
	1.5VL16	8'-2	9'-1	9'-5	400	400	400	400	388	356	328	271	250	232	215	200	187	175	164	
5.50 (t=4.00) 57 psf	1.5VL22	5'-4	6'-3	6'-4	400	400	388	348	314	285	260	238	219	202	186	173	160	149	138	
	1.5VL20	6'-4	7'-5	7'-6	400	400	400	383	346	315	287	263	243	224	208	193	179	167	156	
	1.5VL19	6'-10	8'-2	8'-4	400	400	400	400	374	340	311	286	263	243	226	210	196	183	171	
	1.5VL18	7'-3	8'-9	9'-0	400	400	400	400	400	363	332	305	281	260	241	225	210	196	183	
	1.5VL16	7'-10	8'-9	9'-0	400	400	400	400	400	398	330	303	280	259	240	224	209	195	183	
6.00 (t=4.50) 63 psf	1.5VL22	5'-2	6'-0	6'-1	400	400	400	385	348	315	288	263	242	223	207	191	178	165	153	
	1.5VL20	6'-1	7'-2	7'-3	400	400	400	400	383	348	318	292	269	248	230	214	199	185	173	
	1.5VL19	6'-7	7'-11	8'-0	400	400	400	400	400	377	344	316	291	270	250	233	217	202	189	
	1.5VL18	7'-0	8'-5	8'-9	400	400	400	400	400	400	367	337	311	288	267	249	232	217	203	
	1.5VL16	7'-7	8'-5	8'-9	400	400	400	400	400	400	365	336	310	286	266	248	231	216	202	

Notes:

- Minimum exterior bearing length of 1.5" for 22 to 16 gage.
- Minimum interior bearing length of 2" for 22 to 16 gage.